

CPM-100 Printer

Component Units and Their Functions Front

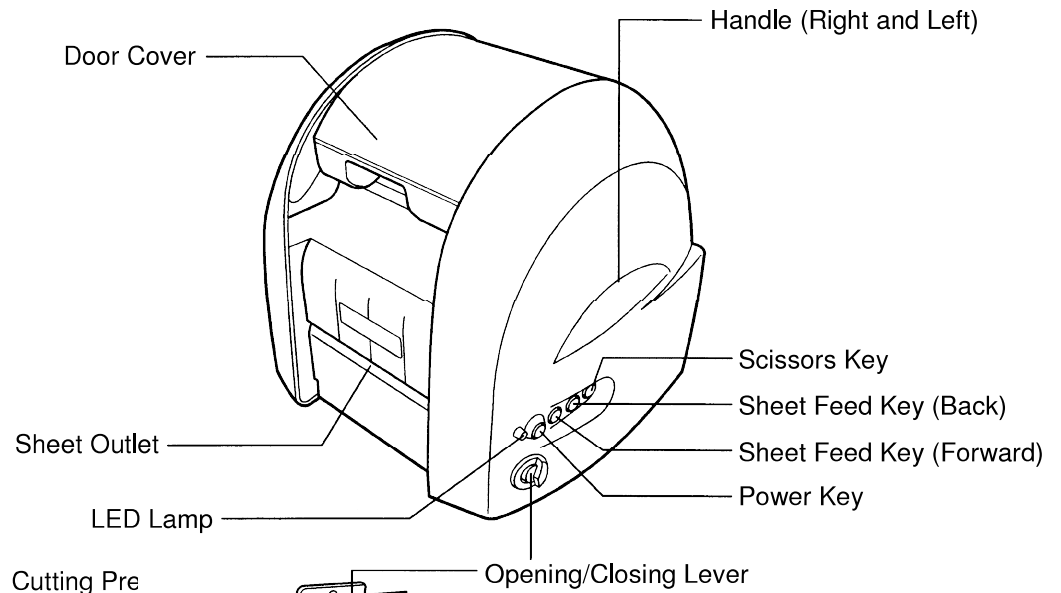

Back

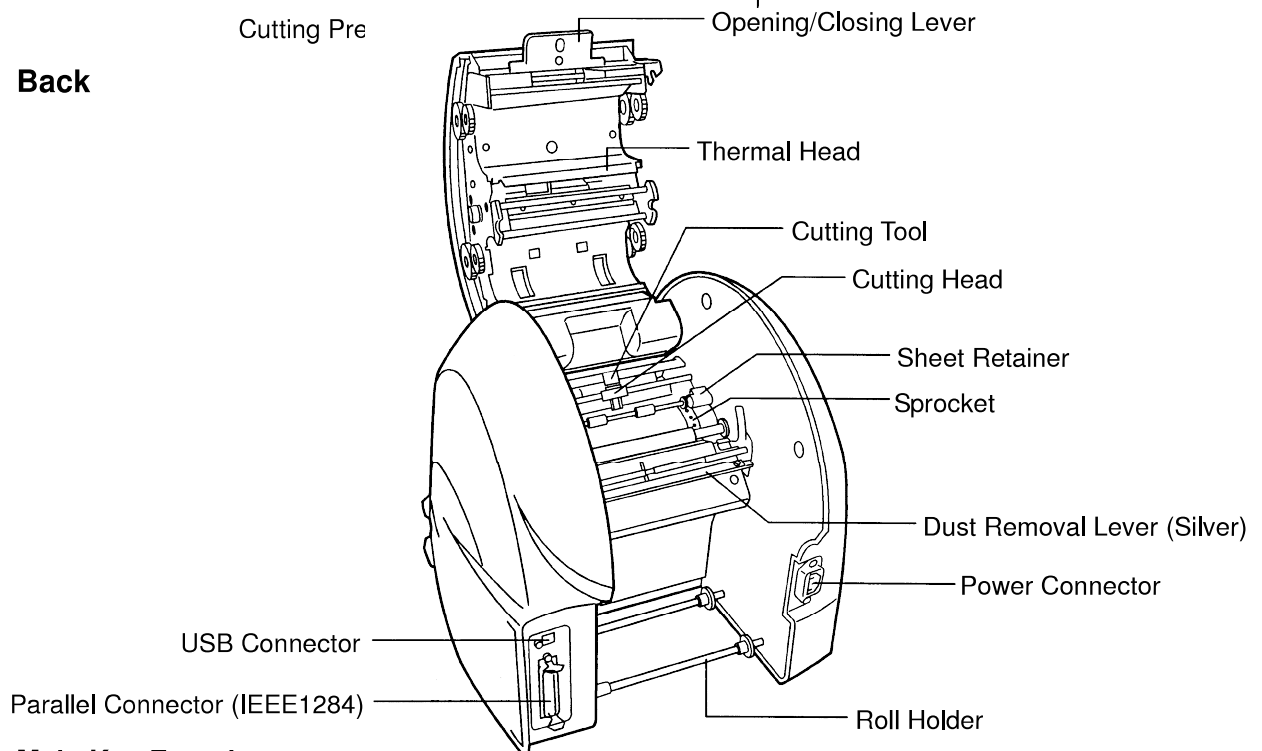

Main Key Functions

- Power key : Used to turn on/off the power.
- Sheet feed keys : Used to feed the vinyl forwards and backwards.
- LED lamp : Usually green when the Power is turned on. Red if in error mode.

Loading The Media

Try not to handle the actual face of the supply roll. Fingerprints, dust and dirt will affect print quality.

1. Turn the power off, lift up the door cover opening/closing lever to open the door cover.

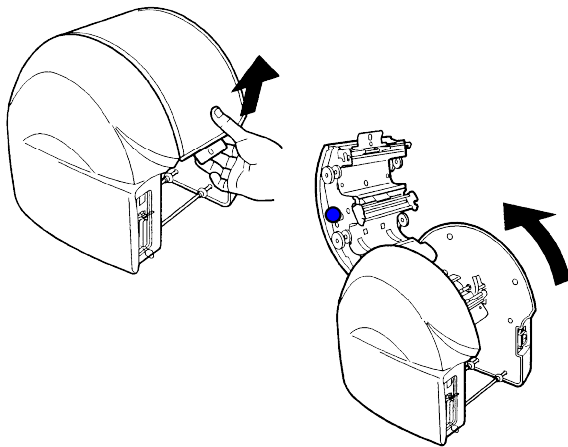

2. Lift up the dust removal lever (silver).

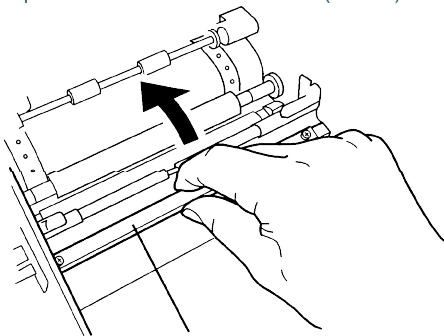

Dust Removal Lever (Silver)

3. Place the Lighthouse vinyl on the sheet holders.

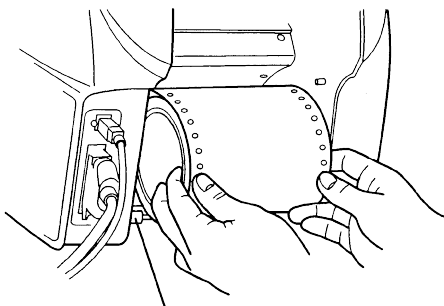

Roll holder

4. Put the sheet through, under the dust removal lever (silver) and over the black platen roller.

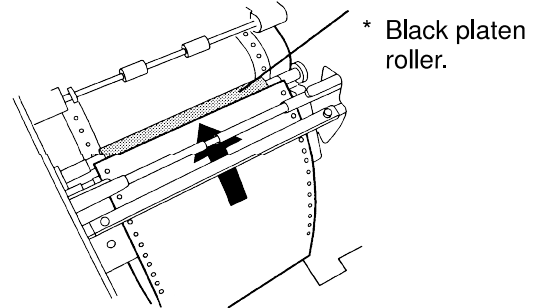

* Black platen roller.

5. Move the vinyl forward and feed it under the two sheet-retaining rollers and the blue plastic bar.

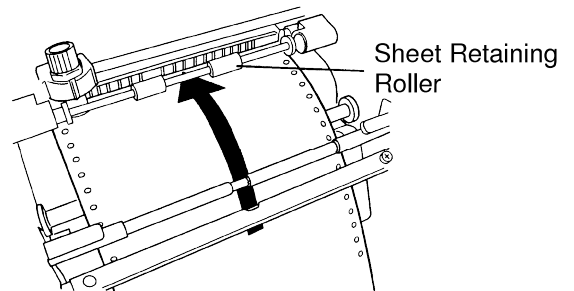

Sheet Retaining Roller

6. Align the holes in the roll with the sprocket pins.

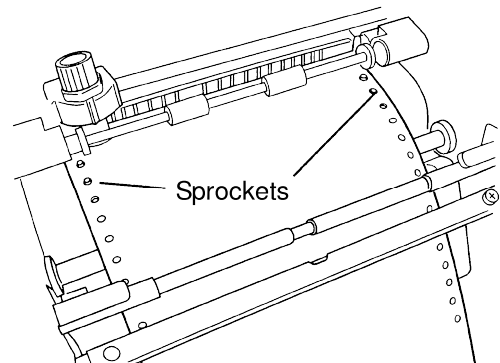

Sprockets

- 7.** Lower the dust removal lever (silver) to hold the vinyl into position.

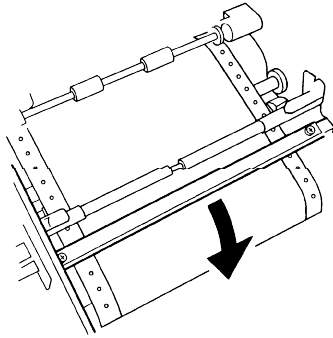

- 8.** Close the door cover until it "clicks" to lock.

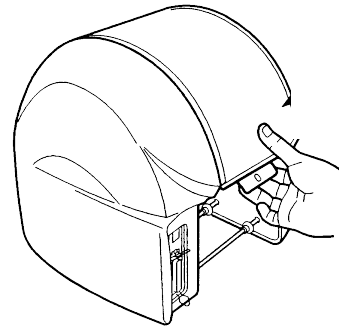

- ☆ Ensure that the rolls are loaded squarely on the sprockets. If they are not loaded properly, the sheet will not run smoothly and may cause an error.

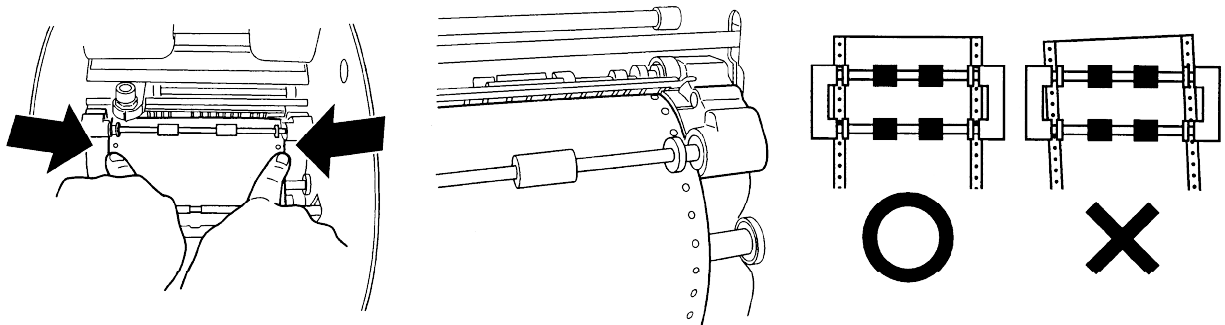

Loading/Unloading the Ink Ribbon Cassette

Inserting the Ink Ribbon Cassette

1. Lift up the opening/closing lever to open the door cover.

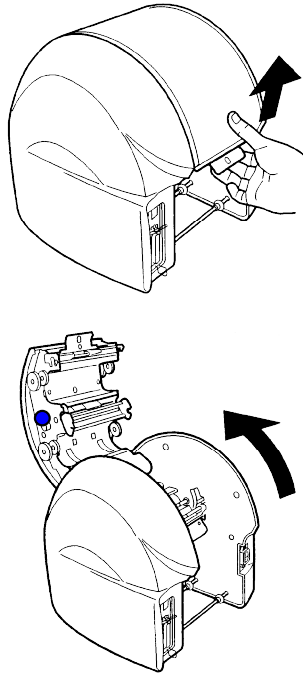

2. Holding the ink ribbon cassette so that its sponge faces downward, turn the ribbon gear in the arrow-indicated direction as shown in the figure to take up the slack of the ink ribbon.

3. Fit the claws of the ink ribbon cassette into the slots in the back of the door cover.

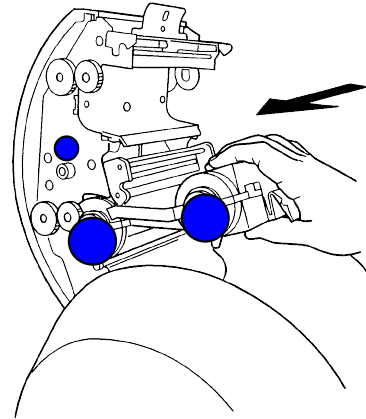

4. Turn the ink ribbon cassette upward, using the claws as leverage. Push it in firmly until the ink ribbon locks with a "click" sound.

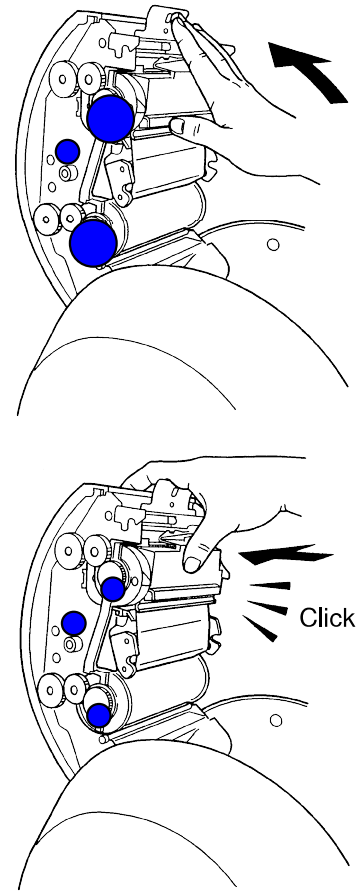
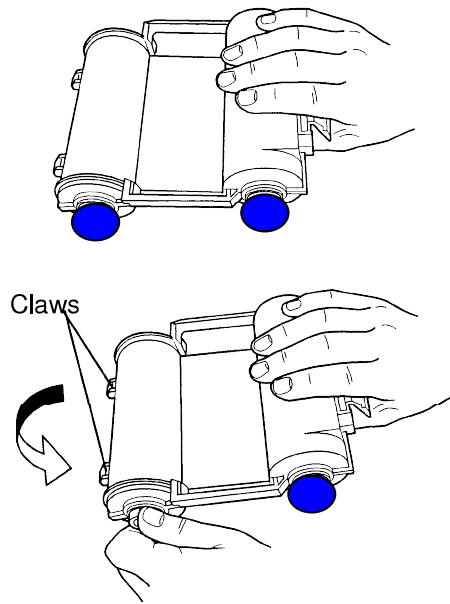

Removing The Ink Ribbon Cassette

1. Open the door cover. Pushing the tab on the ink ribbon cassette, pull it out.
2. Lift the cassette upward and pull it out.

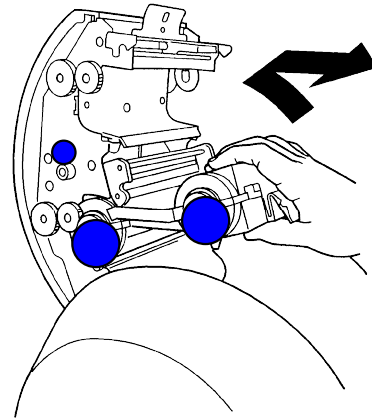
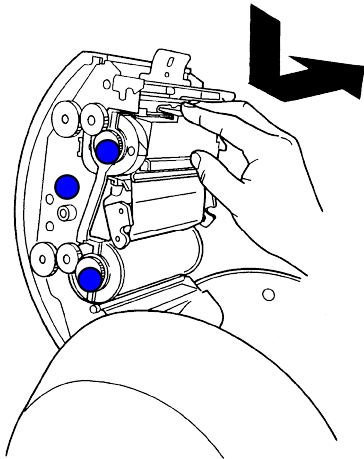

MEMO

- ☆ Ensure that the ribbon is as taut as possible before inserting the cassette into the CPM-100 printer.
- ☆ There is a blue label on one side of the printer lid and a yellow label on the other side. These correspond with the blue and yellow plastic cogs within the ribbon cassette.

How to Refill the Ribbon Cassette

1. The Ribbon Cassette has 4 core inserts (2 yellow and 2 blue) and the physical cassette.



2. Open the cartridge (there should be a green triangle in the lid at the top)

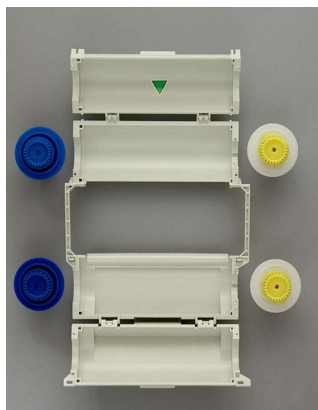

3. Put the blue core inserts into the left side of the ribbon and the yellow inserts into the right.



4. Make sure the ribbon comes from the bottom of the new roll, as in the picture

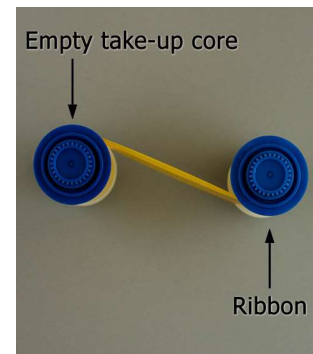

5. Place the ribbon into the cartridge. Ensure the yellow inserts rotate into the recess.

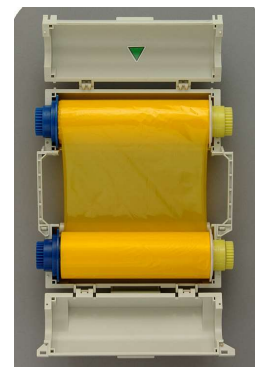

6. Close the cartridge. The cartridge is now ready to be used. To re-use the cartridge remove any dust etc..



Cleaning the Print Head

The print head needs cleaning if the label has speckled print or if there is a tiny continuous missing line where nothing has been printed.

1. Turn off the printer before cleaning the print head and allow the print head to cool for a few minutes.
2. Run the cleaning pen along the print head in one direction a few times.

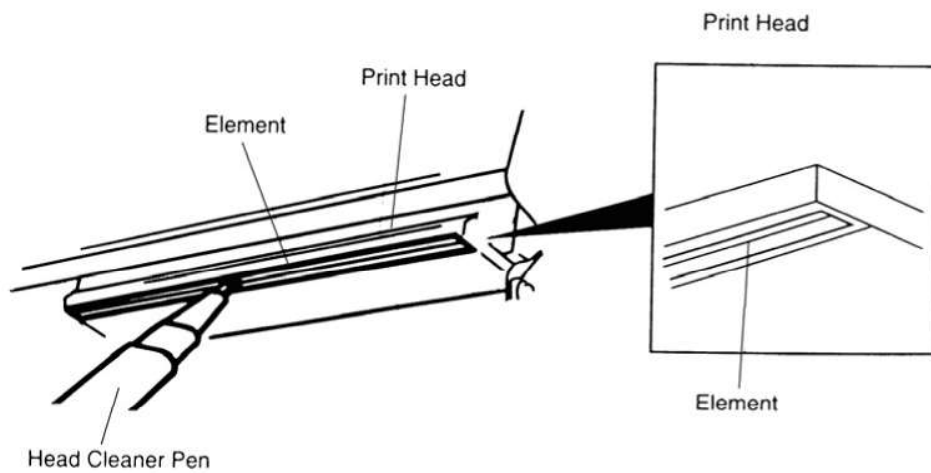

Installing/Replacing The Cutting Tool

- 1.** After turning off the power, lift up the opening/closing lever to open the door cover.

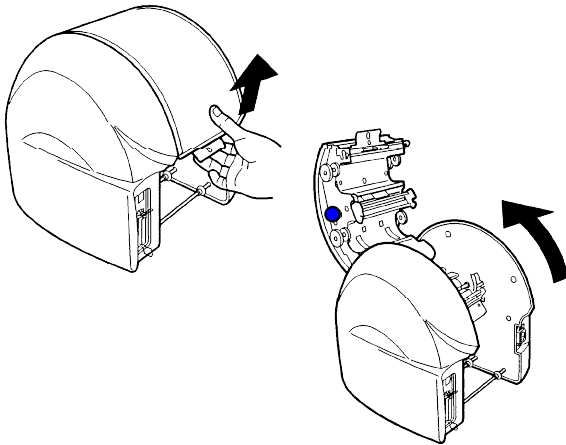

- 2.** Move the cutting head to the center manually.

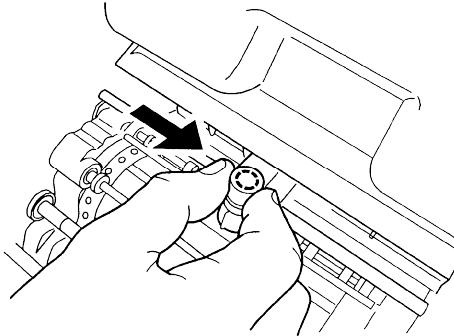

- 3.** Prepare a new cutting tool (blade) and remove its protective cap.

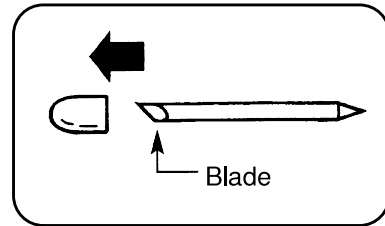

- 4.** Insert/drop the blade into the blade holder and replace the cap. **DO NOT** push the blade into the holder otherwise this will not cut correctly.

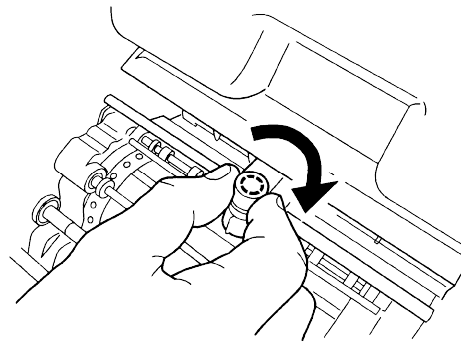

Adjusting the Sheet Cutting Pressure

Cutting depth is adjusted by changing the blade pressure (cutting pressure.) An appropriate cutting pressure leaves a slight trace on the release liner.

1. If the sheet is not properly cut and cannot be peeled off, the cutting pressure is set too low. Increase the dial value, in steps of half a graduation, so that the sheet will be cut properly.
2. If the release paper has also been cut (as far as the back of the release paper), the cutting pressure is too high. Decrease the dial value, in steps of half a graduation.

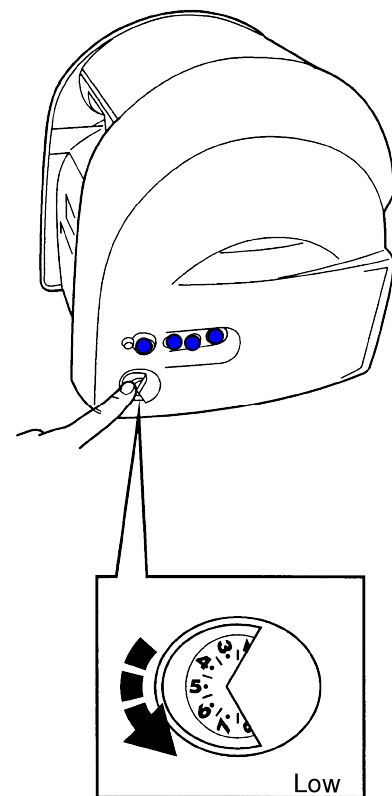
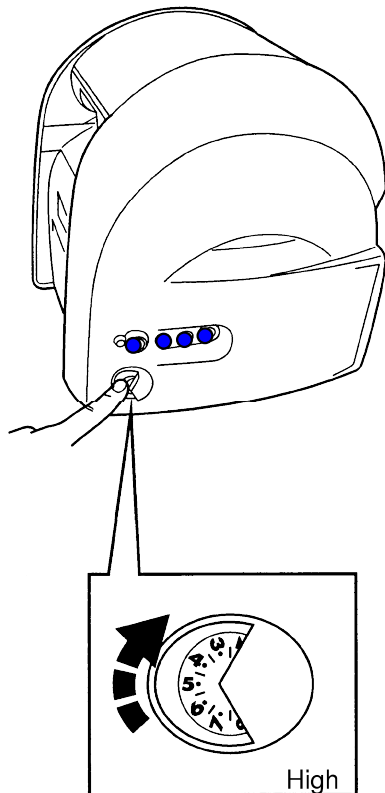

☆ Thicker materials such as reflective, photoluminescent and brushed silver/gold require a higher cutter depth setting. Constant use of these materials will naturally cause more wear on the blade.